

Overload Detection

Ron 1000 Chain Type Overload and / or Underload Detector

TECHNICAL SPECIFICATIONS



Safety Factor: 5:1. Each system proof-loaded to 200% of capacity (certified).

Switching Nature: Normally open and normally closed.

Rating: 0.5A @ 50 VDC, 0.5A @ 125 VAC.

Life Expectancy: Electrical: over 1 million operations. Mechanical: over 5 million operations.

Environment: Weatherproof, NEMA 4, IP 65.

Overload Detection Point: Default: 100% to 110% of capacity.

Temperature Range: -4°F to +175°F (-20°C to +80°C).

Cable Length: 9.5' (3m).

Material: High strength steel.

Wiring:

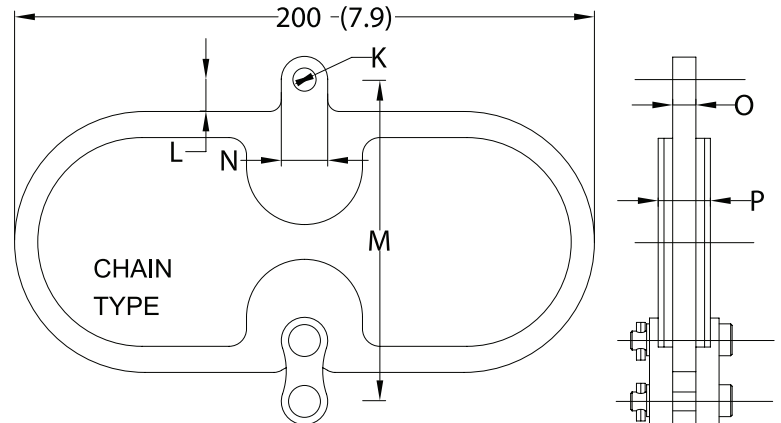
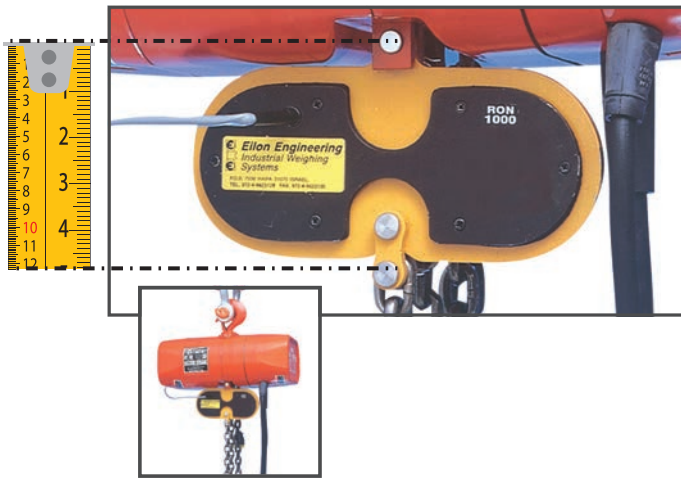
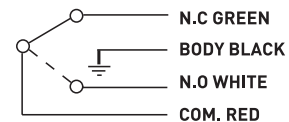

Cat no.	Chain size			Capacity (for one chain fall)	K		L		M Max		N Max		O Max		P Max	
	mm	mm	inch		mm.	inch	mm.	inch	mm.	inch	mm.	inch	mm.	inch	mm.	inch
C-7	6	7	1/4	1.25	8	0.31	12	0.47	115	4.5	20	0.79	6.5	0.26	19	0.75
C-9	8	9	5/16 3/8	1.6	10	0.39	16	0.63	120	4.7	25	1	8.5	0.34	21	0.83
C-11	10	11	7/16	2.0	12	0.47	17	0.67	122	4.8	30	1.2	10.5	0.41	23	0.91

OPTIONS



> Additional detection point.

> The company reserves the right to make changes without notice.