

## Ron 2000 Hook Type Crane Scale with Remote Indicator

### TECHNICAL SPECIFICATIONS



**Safety Factor:** 5:1, for the load cell and the shackle. Average straightening load of the hook is at least 4 times the capacity.

**Proof Load:** Each system proof-loaded to 200% of capacity (certified).

**Accuracy:**  $\pm 0.1\%$  of full range.

**Display:** 5/6 digits, 1/2" (12mm) liquid crystal display with two overload warning levels, max. value (peak hold), low battery, tare state (gross or net), measuring unit, sleep state, charge and programming instructions. Standard number of measurements per second: 1. Standard display update rate per second: 1.

**Functions:** Zero. Tare. Battery charge level. Low battery warning. Max. (peak hold). Two-level overload visual alarms. User calibration. Sleep mode after 60 sec. in zero value, awakes automatically when loaded.

**Sampling Rate:** 200 per second.

**Units:** User selectable units (metric tons, short tons (2000 lbs), kgs, lbs, newtons, deca newtons, k. newtons).

**Load Cell Material:** Made of high-strength, aerospace quality, alloy steel.

**Indicator Material:** ABS

**Power:** 3 x AA 1.5 Volt Alkaline disposable batteries, with battery life indication. Batteries rated 3AH will function up to 2000 hours (three months of continuous working). Occasional use will extend the life of the batteries up to several years. Adding certain options will shorten the life of the batteries. All settings retained at power off.

**Cable:** Supplied with 15" / 5m cable.

**Calibration:** User calibration. Initial factory calibration, fully traceable (certified).

**Temperature Range:**

Load cell:  $-15^{\circ}\text{F}$  to  $+175^{\circ}\text{F}$  ( $-25^{\circ}\text{C}$  to  $+80^{\circ}\text{C}$ ).

Indicator:  $-4^{\circ}\text{F}$  to  $+158^{\circ}\text{F}$  ( $-20^{\circ}\text{C}$  to  $+70^{\circ}\text{C}$ ).

**Environmental:** Weather proof NEMA4, IP65.



Capacities 0.5t - 15t

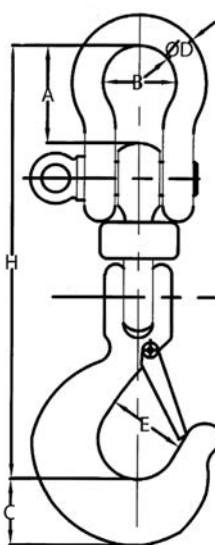

Capacities 20t - 30t

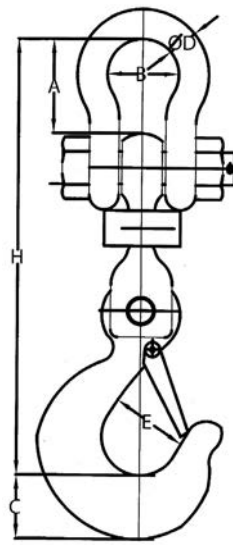

Cat no.	Capacity		Resolution		A		B		C*		Ø D		E*		H	
	ton	kg.	lbs	mm.	inch	mm.	inch	mm.	inch	mm.	inch	mm.	inch	mm.	inch	
H-005	0.5	0.2	0.5	30	1.2	26	1	28	1.1	10	0.4	25	1	235	9.3	
H-01	1	0.5	1	30	1.2	26	1	28	1.1	10	0.4	25	1	235	9.3	
H-0125	1.25	0.5	1	30	1.2	26	1	28	1.1	10	0.4	25	1	235	9.3	
H-016	1.6	1	2	30	1.2	26	1	28	1.1	10	0.4	25	1	235	9.3	
H-025	2.5	1	2	40	1.6	33	1.3	36	1.4	13	0.5	34	1.3	279	11	
H-03	3	1	2	40	1.6	33	1.3	36	1.4	13	0.5	34	1.3	279	11	
H-032	3.2	2	5	40	1.6	33	1.3	36	1.4	13	0.5	34	1.3	279	11	
H-05	5	2	5	50	2	43	1.7	34	1.4	16	0.6	41	1.6	334	13.2	
H-10	10	5	10	82	3.2	68	2.7	58	2.3	25	1	56	2.2	440	17.3	
H-12	12.5	5	10	82	3.2	68	2.7	58	2.3	25	1	56	2.2	440	17.3	
H-15	15	5	10	104	4.1	82	3.2	64	2.5	33	1.3	57	2.2	508	20	
H-20	20	10	20	137	5.3	111	4.3	79	3.1	41	1.6	71	2.8	621	24.5	
H-25	25	10	20	169	6.6	146	5.7	99	3.9	51	2	86	3.4	744	29.3	
H-30	30	10	20	169	6.6	146	5.7	99	3.9	51	2	86	3.4	744	29.3	

> The company reserves the right to make changes without notice.

\* C & E dimensions subject to change. For current dimensions - contact us.

## OPTIONS



- > 1 or 2 user-adjustable set points
- > Additional 0.5"/12mm LCD display with cable connection to indicator or wireless
- > Additional 1"/25mm LCD display with cable connection to indicator or wireless
- > Additional 2"/50mm LCD display with cable connection to indicator or wireless
- > Additional 5"/125mm LED display with cable connection to indicator or wireless
- > Additional extension cable in 15ft/5m increments
- > Analog output: 0 to 3V
- > Analog output: 4 to 20 mA
- > Dampened display for unstable loads
- > Data logger – manual or automatic - up to 600 measurements
- > Data logger – manual or automatic - up to 3,000 measurements

- > Data logger – manual or automatic - up to 6,000 measurements
- > Data logger – manual or automatic - up to 10,000 measurements
- > Indicator belt clip
- > IP 67 load cell with special offshore capability
- > Longer extension cable in 15ft/5m increments
- > Number of measurements per second: 1, 2, 3, factory set
- > Real-time clock: date, hour, minute, second adds time stamp to RS-232 output
- > Rechargeable batteries with an external charger
- > RS-232 - continuous or on demand data output, user-selectable
- > RS-485 - continuous or on demand data output, user-selectable
- > Totalizer
- > Totalizer with Data Logging
- > USB